

CONFERENCE
PROGRAMME

—
**INNOVATION
AND SUSTAINABILITY**
—

*3RD TRANSFORMING CARE
CONFERENCE*



Polytechnic of Milan, Italy
26-28 June 2017



POLITECNICO
MILANO 1863
DIPARTIMENTO DI ARCHITETTURA
E STUDI URBANI



Danish Institute
for Local and Regional
Government Research



laboratorio
politiche
sociali

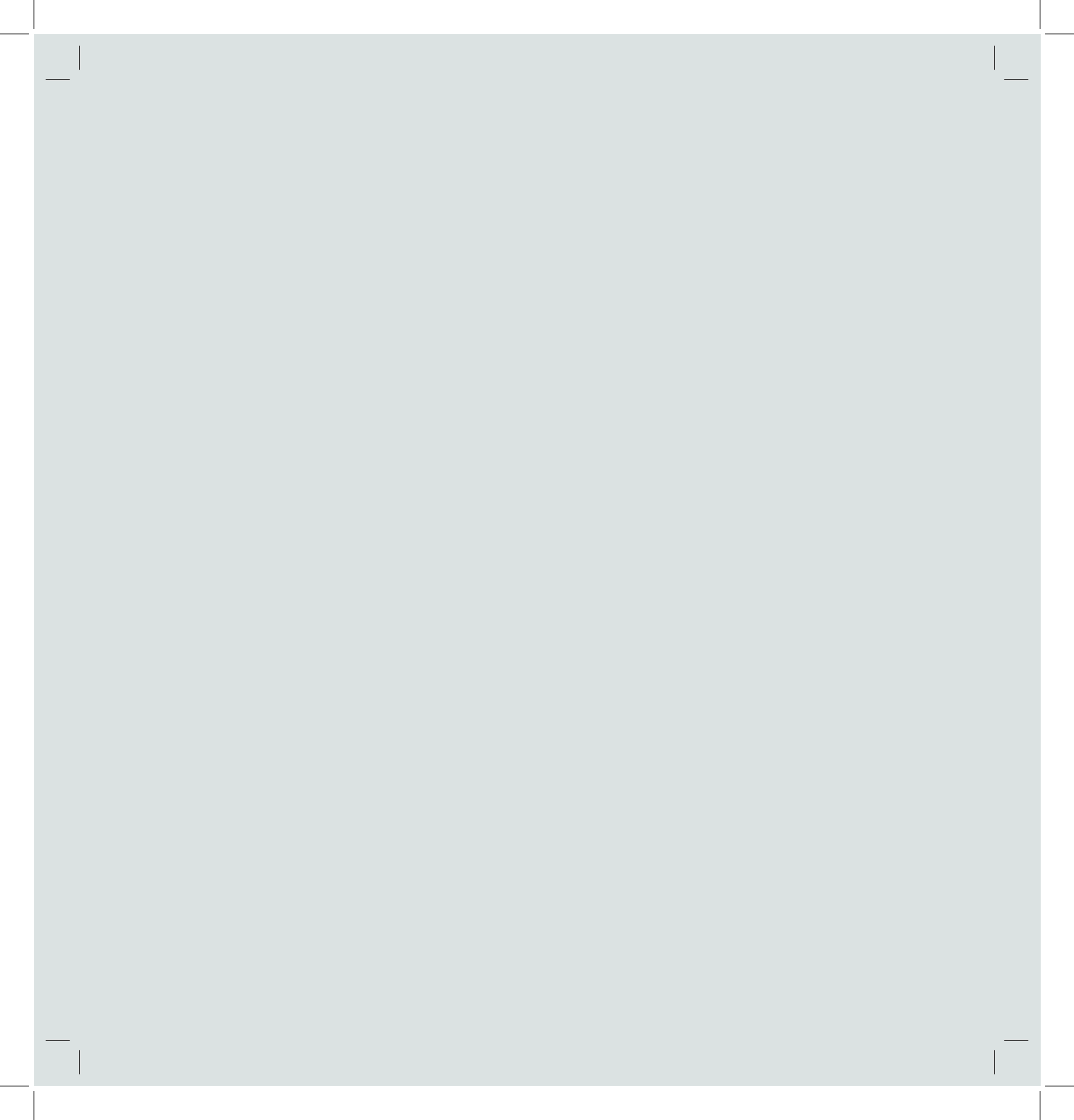

WELCOME TO THE TRANSFORMING CARE CONFERENCE 2017

Dear participant at the 3rd Transforming Care Conference,

We heartily welcome you to the Polytechnic of Milan! We are delighted to be able to continue the Transforming Care Conference series, and we thank you very much for participating and contributing to this event.

Care policies have become an important academic and political issue around the world and as a scientific community, we need a meeting place where our research, results and ideas are presented, circulated and discussed. There is a strong need for international scientific co-operation and exchange, and stronger international comparative research. "Ce n'est qu'un début!": We will meet again in Copenhagen in June 2019.

We hope the conference will help you to enhance your research and interest in this field. And we also hope that you will enjoy Milan, its cultural values and vibrant social atmosphere.

We thank the Polytechnic of Milan, the Department of Architecture and Urban Studies, and KORA, for the support given to this conference. We also wish to thank the scientific committee for valuable advice in planning this event.

Costanzo and Tine

(Conference organizers)

Laura, Marco, Sonia and Stefania

(the Conference team)

LOCAL CONFERENCE COMMITTEE

Dr. Marco Arlotti
Dr. Sonia Galster
Dr. Laura Di Maria
Prof. Costanzo Ranci
Dr. Stefania Sabatinelli

SCIENTIFIC COMMITTEE OF THE CONFERENCE

Prof. Yueh-Ching Chou, National Yang-Ming University, Taiwan
Prof. Margarita Leon, Universitat Autònoma de Barcelona, Spain
Prof. August Österle, Wien University of Business, Austria
Prof. Birgit Pfau-Effinger, Hamburg University, Germany
Prof. Costanzo Ranci, Polytechnic of Milan, Italy
Prof. Tine Rostgaard, KORA – Danish Institute for Local and Regional Government Research, Denmark
Prof. Marta Szebehely, Stockholm University, Sweden
Prof. Dorottya Szikra, Hungarian Academy of Sciences, Center for Social Sciences, Hungary
Prof. Hildegard Theobald, Vechta University, Germany

ORGANIZED BY

Prof. Tine Rostgaard, KORA – Danish Institute for Local and Regional Government Research, Denmark
Prof. Costanzo Ranci, Social Policy Lab, Polytechnic of Milan, Italy

THIS CONFERENCE

Care policies not only need to respond to changing needs by providing good quality services, but also to be financially and socially sustainable, in a long-term and inter-generational perspective, and from the perspectives of care users, their families and paid care workers. This is a difficult challenge for policies as well as for informal and formal care practices, with strong implications as to how care services and care work are organized and provided.

The conference focuses on the tensions between policy and social innovation in care policies on the one hand, and pressures for financial and social sustainability of care systems on the other. This complex topic will be addressed from different perspectives through 20 thematic panels, 5 symposia, 3 keynote addresses, and a final round table discussion.

Thematic panels are organized in five parallel tracks:

- Care policy and institutional setting
- Innovation and trade-offs in care services
- Intergenerational care arrangements and informal care
- Care work and changing care arrangements
- Care policy in different care regimes

The conference addresses transforming trends in the following fields: childcare and care for frail older people as well as for people with disabilities, in an attempt to capture not only the specific features of these fields but also their commonalities and transversal themes.

LOCATION

Polytechnic of Milan
Department of Architecture and Urban Studies
Via Ampère 2, Milano

Ground Floor

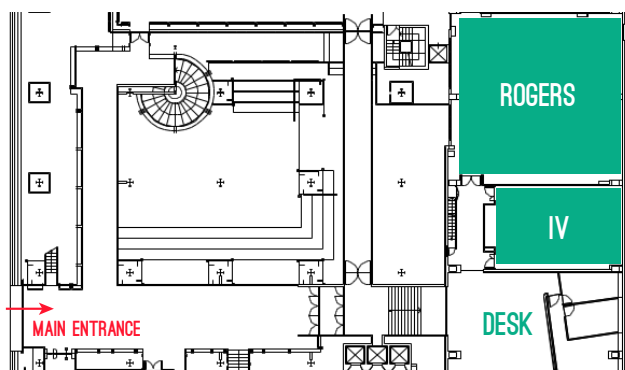

First Floor

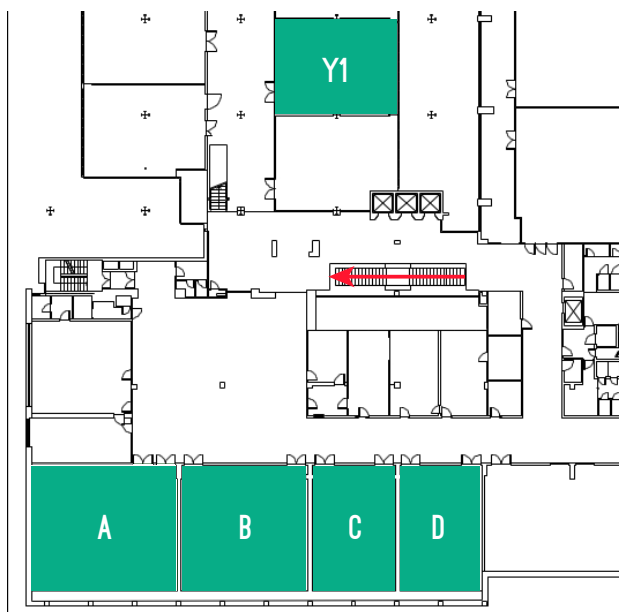

CONFERENCE KEYNOTES



CHIARA SARACENO

Monday, 26 June, 14.00-15.00

Room Rogers

Chiara Saraceno is Honorary Fellow at the Collegio Carlo Alberto of Turin and very well known for her studies on family, women's issues, poverty, and social policies. She

has held many academic and institutional posts in Italy as well as in the international context, and in the 1990s and early 2000s she participated in two government commissions on poverty studies, being also president of one of them between 1999 and 2001.



AUGUST ÖSTERLE

Monday, 26 June, 17.30-18.30

Room Rogers

August Österle is Professor of Social Policy and Deputy Head of the Institute for Social Policy of the WU Vienna University of

Economics. His main focus in research and teaching: social policy and comparative welfare state analysis, especially in the fields of health and long-term care; transnational social security; access to social rights; equity and social policy.



ANNELI ANTTONEN

Tuesday, 27 June 2017, 11.30-12.30

Room Rogers

Anneli Anttonen is Professor of Social Policy at the University of Tampere. She has published extensively on change,

universalism and citizenship. A new edited book on "Social Services Disrupted: Changes, Challenges and Policy Implications for Europe in Times of Austerity" will be published 2017 by Edward Elgar.

CONFERENCE SCHEDULE

MONDAY 26 JUNE

13.30 Opening
 Gabriele Pasqui,
Head of the Department of Architecture
and Urban Studies

14.00-15.00 Keynote: Chiara Saraceno,
Collegio Carlo Alberto di Moncalieri, Italy
*Two different discourses on sustainability in social
care with regard to children and the frail old*

Coffee break

15.30-17.15 Parallel Session A

17.30-18.30 Keynote: August Österle,
WU Vienna University of Economics and
Business, Austria
Long-term care and social sustainability

20.00 Welcome reception
 (Sforza Castle)

TUESDAY 27 JUNE

9.00-11.00 Parallel session B

Coffee break

11.30-12.30 Keynote: Anneli Anttonen,
University of Tampere, Finland
*Three decades of care research: what we can
learn about the sustainability of care policies?*

Lunch

14.00-16.00 Parallel session C

Coffee break

16.30-18.30 Parallel session D

20.00 Conference Dinner

WEDNESDAY 28 JUNE

9.00-11.00 Parallel session E

Coffee break

11.30-13.00 Round Table discussion
*A comparative perspective of marketization and
free choice in care policies: same word, different
meanings?*

Chair: Tine Rostgaard (KORA – Danish Institute for
Local and Regional Research, Denmark)

Panelists:

Yueh-Ching Chou (Yang-Ming University, Taiwan),
Karen Christensen (University of Bergen, Norway),
Birgit Pfau-Effinger (University of Hamburg,
Germany), Costanzo Ranci (Polytechnic of Milan,
Italy), Sue Yeandle (University of Sheffield, England)

THEMATIC PANELS

TRACK 1 - CARE POLICY AND INSTITUTIONAL SETTING

Thematic Panel 2

The varieties of multi-level governance systems in long term care: opportunities and risks

Thematic Panel 3

Cui bono? Policy design and inequalities in access, use and outcomes of car

Thematic Panel 4

Social investment and long-term care - is there a connection?

Thematic Panel 22

Macro comparative perspectives on care policies

TRACK 2 - INNOVATION AND TRADE-OFFS IN CARE SERVICES

Thematic Panel 5

Personalization and user participation in care for older people and people with disability: between innovation and marketization

Thematic Panel 8

Reablement as a strategy to regain independence: its challenges and impacts

TRACK 3 - INTERGENERATIONAL CARE ARRANGEMENTS AND INFORMAL CARE

Thematic Panel 11

New shapes of intergenerational care relationship

Thematic Panel 12

Co-production between new care arrangements and informal practices for chronic conditions

Thematic Panel 13

Making-up caregivers. How policy instruments frame and enroll family and informal caregivers?

TRACK 4 - CAREWORK AND CHANGING CARE ARRANGEMENTS

Thematic Panel 14

Men as paid care workers: barriers and opportunities for their incorporation in elder and long-term

Thematic Panel 15a

Care work in different arenas: organization, work content and working conditions

Thematic Panel 15b

Care work in different arenas: organization, work content and working conditions

Thematic Panel 16

Working conditions and every-day life of migrant care workers in different care regimes

TRACK 5 - CARE POLICY IN DIFFERENT CARE REGIMES

Thematic Panel 17

Family-based caregiving under transforming regimes: challenges and opportunities in Asian societies

Thematic Panel 19

The Mediterranean Big Chill? Factors, trends and impacts of care policies inertia in Southern European countries

Thematic Panel 20

Post-communist transformation and transforming care: Central and Eastern Europe in comparative perspective

Thematic Panel 21

Care policies in the Global South

TRACK 6 - SUSTAINABLE INNOVATION IN CARE POLICY

Thematic Panel 6

Achieving sustainable innovation in care: identifying effective pathways for scaling-up

Thematic Panel 9

Technological innovation and social investment strategies in the care sector: challenges and opportunities

Thematic Panel 26

Quality of care

SYMPOSIA

Symposium 1

Privatization/ marketization in Residential Care for Older People

Symposium 2

Changing Policies towards Family Care and Extra-Familial Care and their Consequences
– Theoretical Approaches, Concepts and Typologies

Symposium 3

The transformation of cash-for-care payments for older people in Europe

Symposium 4

Providing a Non-Institutional Environment in the Nursing Home: Promising Practices from Sweden?

Symposium 6

Characteristics of long-term care of the older people – new perspectives from SHARE data

CONFERENCE PROGRAMME AT A GLANCE

MONDAY 26 JUNE

13.30	Opening					
14.00-15.00	Chiara Saraceno - Room Rogers					
	<i>Coffee break</i>					
15.30-17.15	TP4 IV	TP6 A	TP11 Y1	S6 B	TP17 D	TP16 C
17.30-18.30	August Österle - Room Rogers					
20.00	Welcome reception (Sforza Castle)					

TUESDAY 27 JUNE

9.00-11.00	TP3 IV	TP5 A	TP13 Y1	S4 B	TP19 D	
	<i>Coffee break</i>					
11.30-12.30	Anneli Anttonen - Room Rogers					
	<i>Lunch</i>					
14.00-16.00	TP2 IV	TP8 A	TP12 Y1	S3 B		TP15a C
	<i>Coffee break</i>					
16.30-18.30	TP22 IV	TP9 A		S2 B	TP21 D	TP15b C
20.00	Conference Dinner					

WEDNESDAY 28 JUNE

9.00-11.00		TP26 A		S1 B	TP20 D	TP14 C
	<i>Coffee break</i>					
11.30-13.00	Round Table - "Nave" Building					

Note:

TP = Thematic Panel / S = Symposium

EVENTS

GUIDED TOUR OF THE PIETÀ RONDANINI BY MICHELANGELO

Monday, 26 June 2017,
19.15 / 19.45
Sforza Castle



Piazza Castello, 20121 Milano
www.milanocastello.it

The last incomplete work by Michelangelo Buonarroti (1475-1564), the Pietà, is a meditation on death and the salvation of the soul.

The tour will be organised in two slots:

- first turn at 19.15
- second turn at 19.45

Priority will be given on a 'first come, first served' criteria. Please consider that each tour group cannot exceed 50 persons, so please be there on time!



WELCOME RECEPTION

Monday, 26 June 2017,
20.00
Sforza Castle,
Cortile della Rocchetta



Piazza Castello, 20121 Milano
www.milanocastello.it

The Sforza Castle was built in the 15th century by Francesco Sforza, Duke of Milan, on the remains of a 14th-century fortification. Later renovated and enlarged, in the 16th and 17th centuries it was one of the largest citadels in Europe. Extensively rebuilt during the 19th century, it now houses several of the city's museums and art collections.

Take Metro Line 2 (green line) towards Abbiategrasso – Assago. Change to Metro 1 at Loreto (only 1 stop). Take Metro Line 1 (red line) towards Rho-Fiera Stop at Cairoli. From there, about 300 mt walking.



CONFERENCE DINNER

Tuesday, 27 June 2017,
20.00
"El Brellin"



Vicolo dei Lavandai
ang. Alzaia Naviglio Grande, 14
20144 Milano
www.brellin.com

Located in the historic area of the Navigli the restaurant "El Brellin" offers in a characteristic setting traditional dishes but also creativity according to the "Milanese" style.

How to reach the restaurant from the Polytechnic: take Metro Line 2 (green line) towards Abbiategrasso – Assago. Stop: Porta Genova. From there, about 400 mt walking.

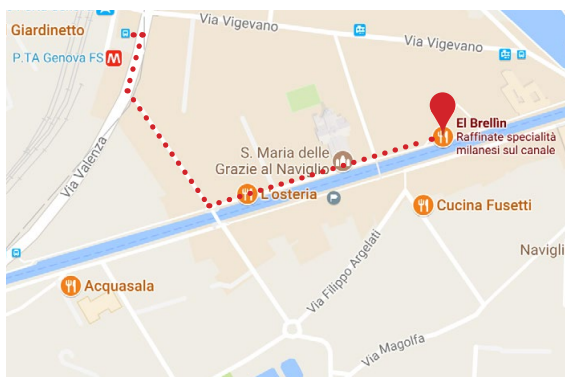

MON
26
JUN

15.30
17.15

TRACK 1: CARE POLICY AND INSTITUTIONAL SETTING

THEMATIC PANEL 4

SOCIAL INVESTMENT AND LONG-TERM CARE - IS THERE A CONNECTION?

Room IV

Chair: **Bent Greve**

Dario Barbieri, Luca Ghibelli

*Role of public and private actors in
delivering and resourcing long-term
care services*

Virginija Poskute

*Are Concepts of Social Investment
and Long-term Care Compatible?
Perceptions of Long-term Care
Stakeholders in Lithuania*

Bent Greve

*Do stakeholders in Denmark know
about social investment?*

THEMATIC PANEL 3

**CUI BONO? POLICY DESIGN
AND INEQUALITIES IN ACCESS,
USE AND OUTCOMES OF CARE**

Room IV

Chairs: **Ricardo Rodrigues,
Andrea E. Schmidt**

Peteke Feijten, Frieke Vonk
*Social support in the Netherlands:
local policies and individual outcomes*

**Kate Baxter, Emily Heavey,
Yvonne Birks**
*Self-funders' access to information
about long-term care in England*

**Arianna Santero,
Manuela Naldini**
*Immigrants' Access to Public
Childcare Family Benefits in Italy*

Rosy Musumeci
*Public health services in perinatal
care: characteristics and experiences
of native and immigrant users in Italy*

**TUE
27
JUN**

**9.00
11.00**

TRACK 1: CARE POLICY AND INSTITUTIONAL SETTING

TUE
27
JUN

14.00
16.00

TRACK 1: CARE POLICY AND INSTITUTIONAL SETTING

THEMATIC PANEL 2

THE VARIETIES OF MULTI-LEVEL
GOVERNANCE SYSTEMS IN LONG
TERM CARE: OPPORTUNITIES
AND RISKS

Room IV

Chairs: **Marco Arlotti,**
Manuel Aguilar Hendrickson

Young Jun Choi, Hye-jin Choi

*Why the Discretion Mix Matters:
Understanding the Transformation of
Long-Term Care Services*

Raquel Martínez-Buján

*A comparison of regional
configurations for public provision of
long-term care in Spain.*

Kirstein Rummery

*Gender Equality and the Governance
of Long-term Care Policy: new models
and paradigms*

Olivier Giraud, Barbara Lucas

*A Multiscalar Comparative Method
for the Analysis of Long term Care
Reforms*

THEMATIC PANEL 22

MACRO COMPARATIVE PERSPECTIVES ON CARE POLICIES

Room IV

Chair: **Costanzo Ranci**

**Zafiris Valvis, Antigone Lyberaki,
Platon Tinios, Thomas Georgiadis**

Tracking demand and supply for long term care in Europe 2007-2015: A cross-national intertemporal analysis using three waves of SHARE data

Luppi Matteo, Tiziana Nazio

Does gender trump family ties? Intra- and inter- household sharing of caring responsibilities for elderly parents and in-laws

**Gloria Moreno, Inmaculada Cebrián,
María A. Davia, Nuria Legazpe**

Mothers' employment and child care choices across the European Union: different patterns in different welfare regimes

Chiara Giordano

Combining care and gender regimes: the use of typologies to explain cross-European differences in paid domestic work

**Rahel Strohmeier Navarro Smith,
Konstantin Kehl**

Long-term care and intermediary structures for frail older people: a comparative view on access, use and outcomes in Germany and Switzerland

3RD TRANSFORMING CARE CONFERENCE

TUE
27
JUN

16.30
18.30

TRACK 1: CARE POLICY AND INSTITUTIONAL SETTING

21

TUE
27
JUN

9.00
11.00

TRACK 2: INNOVATION AND TRADE-OFFS IN CARE SERVICES

THEMATIC PANEL 5

PERSONALIZATION AND USER
PARTICIPATION IN CARE FOR
OLDER PEOPLE AND PEOPLE WITH
DISABILITY: BETWEEN INNOVATION
AND MARKETIZATION

Room A

Chairs: **Karen Christensen,**
Yueh-Ching Chou

Qingyun Fan

*"Seniors Surfing" - Case Study on
a New Type of Welfare Service in
Finland*

**Daniel Lombard, Stefanie Ettelt,
Raphael Wittenberg,
Lorraine Williams, Jackie Damant,
Margaret Perkins,
Nicholas Mays**

*Introducing Direct Payments in
Residential Care – the experience of
care home providers*

Chia-Ning Chang

*Job or Companionship? - The
Relationship between Personal
Assistant and Disabled people in
Taiwan*

**Yueh-Ching Chou, Chun-Chieh Lin,
Chia-Ning Chang, Teppo Kröger**

*Personal assistance (PA) as an
innovation in Taiwan: features,
barriers and service user
participation*

THEMATIC PANEL 8

REABLEMENT AS A STRATEGY TO REGAIN INDEPENDENCE: ITS CHALLENGES AND IMPACTS

Room A

Chairs: **Rudi Westendorp,**
Avril Drummond

Lea Graff, Tine Rostgaard

*Assisting you with my hands in my
pockets: How reablement in home
care for older people transforms
problems, roles and relations*

Mia Vabø

*Reablement in the making – the
significance of local government
organization*

Eva Langeland, Hanne Tuntland, Bjarte Folkestad, Oddvar Førland, Frode F. Jacobsen, Ingvild Kjekken

*A multicenter investigation of
reablement in Norway: a clinical
controlled trial*

Magnus Zingmark, Elisabeth Biberg

*Feasibility of health promoting senior
meetings*

TUE
27
JUN

14.00
16.00

TRACK 2: INNOVATION AND TRADE-OFFS IN CARE SERVICES

MON
26
JUN

15.30
17.15

TRACK 3: INTERGENERATIONAL CARE ARRANGEMENTS AND INFORMAL CARE

THEMATIC PANEL 11

NEW SHAPES OF INTERGENERATIONAL CARE RELATIONSHIP

Room Y1

Chairs: **Tiziana Nazio, Matteo Luppi**

Junko Yamashita, Naoko Soma

The Double Responsibilities of Care in Japan: Emerging New Social Risks for Women Providing both Childcare and care for the Elderly

**Alison Bowes, Alison Dawson,
Rosalie Ashworth**

Carers time use: Preliminary findings from time use diaries

Chih-Yao Lee

Child Care by Grandmothers: Work and Care Reconciliation

THEMATIC PANEL 13

**MAKING-UP CAREGIVERS. HOW
POLICY INSTRUMENTS FRAME
AND ENROLL FAMILY AND
INFORMAL CAREGIVERS?**

Room Y1

Chairs: **Olivier Giraud, Barbara Lucas**

Petra Ulmanen

*Family care in the Swedish
welfare state: extent, content and
consequences*

Reiko Ogawa

*Transformation of Care in East Asia:
Migration and Emerging Regional
Care Chain*

Liina Sointu

*Slipping into 'that nurse's dress':
caring as affective practice in couples'
relationships*

Lina Van Aerschot, Olli Karsio

*Care generating publicly governed
markets – The Finnish voucher system*

TUE
27
JUN

9.00
11.00

TRACK 3: INTERGENERATIONAL CARE ARRANGEMENTS AND INFORMAL CARE

TUE
27
JUN

14.00
16.00

TRACK 3: INTERGENERATIONAL CARE ARRANGEMENTS AND INFORMAL CARE

THEMATIC PANEL 12

CO-PRODUCTION BETWEEN NEW CARE ARRANGEMENTS AND INFORMAL PRACTICES FOR CHRONIC CONDITIONS

Room Y1

Chairs: **Micol Bronzini, Chiara Guglielmetti**

Enrico Maria Piras, Silvia Fornasini, Francesco Miele

Unpacking the invisible work of informal practices in shared care arrangements. The case of Type1 Diabetes management in the family setting.

Abigail Johnson, Jenny Mendez, Sharon Milberger, Jane Turner

Training leaders in Interprofessional Practices: A model of Co-production care for children with disabilities.

Paolo Rossi, Monica Colombo

The co-design and co-production of social welfare services in Italy: an innovative practice with complex alignments and multiple meanings

Julie MacInnes, Jenny Billings, Erica Gadsby, Simone De Bruin, Jillian Reynolds, Georg Ruppe, Christine Hausler, Caroline Baan

Sustainable Tailored Integrated Care for Older People in Europe (SUSTAIN): Challenges to Implementation at UK, Austria and Catalonia sites

CONTRIBUTED PAPER:

Chiara Guglielmetti

Co-production in Italy: what do we know?

THEMATIC PANEL 16

WORKING CONDITIONS AND EVERY-DAY LIFE OF MIGRANT CARE WORKERS IN DIFFERENT CARE REGIMES

Room C

Chairs: **Brunella Casalini,**
Rossana Trifiletti

Peter Abrahamson

*Domestic migrant care workers in
Argentina: Work as no other*

Marco Arlotti, Stefania Cerea, Marta Cordini, Costanzo Ranci

*Same words, different ideas? The
social construction of care markets in
Italy and UK*

Simone Leiber, Verena Rossow

*Transnationally Acting Brokering
Agencies: Improving Working
Conditions for Live-in Migrant Care
Workers in a Europeanized Welfare
Market?*

Rossana Trifiletti

*Under the Brunt of the Crisis: Life
Trajectories of Migrant Care-Workers
in Italy*

MON
26
JUN

15.30
17.15

TRACK 4: CAREWORK AND CHANGING CARE ARRANGEMENTS

TUE
27
JUN

14.00
16.00

TRACK 4: CAREWORK AND CHANGING CARE ARRANGEMENTS

THEMATIC PANEL 15A

CARE WORK IN DIFFERENT ARENAS: ORGANIZATION, WORK CONTENT AND WORKING CONDITIONS

Room C

Chair: **Marta Szebehely**

Sara Charlesworth, Deb King

*Improving Job Quality in Aged Care:
Challenges and Dilemmas*

Chin-fen Chang

*Resistance or Loyalty? Interpreting
Nurses' Organizational Commitment
in Taiwan*

**Teppo Kröger,
Jiby Mathew Puthenparambil**

*Nordic Care Work under Change:
Trends in Working Conditions in
Denmark, Finland, Norway and
Sweden*

**Margarita Leon, Costanzo Ranci,
Stefania Sabatinelli,
Zyab Ibáñez**

*Childcare and Labour markets: What
makes Social Investment?*

THEMATIC PANEL 15B

CARE WORK IN DIFFERENT ARENAS: ORGANIZATION, WORK CONTENT AND WORKING CONDITION

Room C

Chair: **Marta Szebehely**

Tine Rostgaard

Providing free choice in a public long-term care system in Denmark – the implication for care workers' tasks, working conditions and evaluation of quality of care

Stefano Neri, Lisa Dorigatti, Anna Mori

Behind the scenes of social service provision in Italy. Workers, wages and working conditions across the public/private divide

Sigrid Rand

Coping with the working conditions in German nursing homes: the struggle of foreign-trained nurses between professional acknowledgement and adaptation

TUE
27
JUN

16.30
18.30

TTTRACK 4: CAREWORK AND CHANGING CARE ARRANGEMENTS

WED
28
JUN

9.00
11.00

TRACK 4: CAREWORK AND CHANGING CARE ARRANGEMENTS

THEMATIC PANEL 14

**MEN AS PAID CARE WORKERS:
BARRIERS AND OPPORTUNITIES
FOR THEIR INCORPORATION IN
ELDER AND LONG-TERM**

Room C

Chairs: **María Offenhenden, Natalia
Alonso Rey**

**Yolanda Bodoque-Puerta,
Montserrat Soronellas Masdeu**
*Immigrant men in care work:
Crossing gender barriers*

Julie Aguirre
*Talking to Men in Care: Analysis of
the Narratives of Men Immigrants
caregivers in the Basque Country*

Carla Aguilar-Cunill
Men in a Feminized Work

**Ramona Torrens, Mònica Gelambí,
Dolors Comas d'Argemir**
*Local policies and gender equality:
men as workers in home-based
municipal social care services*

THEMATIC PANEL 17

FAMILY-BASED CAREGIVING UNDER TRANSFORMING REGIMES: CHALLENGES AND OPPORTUNITIES IN ASIAN SOCIETIES

Room D

Chairs: **Phyllis King Shui Wong**

Tine Rostgaard

Re-producing familism? Approaches to Community-Based Social Care in East and Southeast Asian Countries

Tae-Young Yun

Hybrid Status of Family Care Helpers in the Long-Term Care Insurance in South Korea

Phyllis King Shui WONG, Ritter Cho Fung YEUNG, Melody Hiu Ying FUNG
Impact of Caring on Hong Kong Caregivers of People with Disabilities

Shu-Er Wei, Jen-Der Lue

Social investment for children or elderly? - A Case Study of Taichung City's Childcare and Elder Care Reforms in Taiwan.

MON
26
JUN

15.30
17.15

TRACK 5: CARE POLICY IN DIFFERENT CARE REGIMES

TUE
27
JUN

9.00
11.00

TRACK 5: CARE POLICY IN DIFFERENT CARE REGIMES

THEMATIC PANEL 19

THE MEDITERRANEAN BIG CHILL? FACTORS, TRENDS AND IMPACTS OF CARE POLICIES INERTIA IN SOUTHERN EUROPEAN COUNTRIES

Room D

Chairs: **Barbara Da Roit, Stefania Sabatinelli**

Costanzo Ranci, Marco Arlotti, Andrea Parma

Traps and unexpected effects of innovation in a context of institutional inertia: the case of Italian "Home care premium" program

Manuel Aguilar-Hendrickson

10 years of top-down universalistic reform of LTC in a Southern European welfare state: Spain and the LAPAD

Giovanni Lamura

Elder care needs and service provision in Italy: current challenges for policy and practice in an international perspective

Sergio Pasquinelli

Collaborative welfare: evidence beyond the storytelling

CONTRIBUTED PAPER:

Flavia Martinelli, Stefania Barilla', Antonella Sarlo

Public ECEC services in the South of Italy. Explaining an enduring deficit in the city of Reggio Calabria

THEMATIC PANEL 21

CARE POLICIES IN THE GLOBAL SOUTH

Room D

Chair: **Margarita Leon**

Peter Abrahamson

*Solving the care crisis in Latin
America: Family, market or state*

Vivián Díaz

*Innovative systems of care for elderly
people: An analysis from a gender and
territorial perspective*

Karina Batthyany

*Policies and care provision in
Latin America. A view of regional
experiences and the particular case of
the national care system in Uruguay*

Reyhan Atasu Topcuoglu

*Working conditions in the disability
care sector of Turkey: a comparison
between institutional care and care
at home*

TUE
27
JUN

16.30
18.30

TRACK 5: CARE POLICY IN DIFFERENT CARE REGIMES

WED
28
JUN

9.00
11.00

TRACK 5: CARE POLICY IN DIFFERENT CARE REGIMES

THEMATIC PANEL 20

POST-COMMUNIST TRANSFORMATION AND TRANSFORMING CARE: CENTRAL AND EASTERN EUROPE IN COMPARATIVE PERSPECTIVE

Room D

Chair: **Paweł Łuczak**

**Gojko Bezovan, Jelena Matancevic,
Danijel Baturina**

*Social Innovation- From
Civic Engagement to Social
Entrepreneurship*

Márton Medgyesi

*Help and care from children to elderly
parents: Hungary in European context*

Borbála Kovács

*Explaining income-based differences
in accessing full-time early childhood
education and care services in urban
Romania*

CONTRIBUTED PAPER:

Andrea Racz

*Opportunities and risks in the field
of professionalism in the Hungarian
child protection system*

THEMATIC PANEL 6

ACHIEVING SUSTAINABLE INNOVATION IN CARE: IDENTIFYING EFFECTIVE PATHWAYS FOR SCALING-UP

Room A

Chair: **Katharine Schulmann,
Gudrun Bauer**

Henk Nies

*What makes it work? Evaluation of
an eight-year national sustainability
program in LTC*

Laurent Fraise, Anne Eydoux, Elisabetta Bucolo

*Innovating for a better access of
children of working lone parent to
childcare facilities: reframing local
childcare system or encouraging the
additional private solutions?*

Herve Hudebine

*A new public governance in regional
and local social and long term
care policies? The French case in a
comparative perspective*

MON
26
JUN

15.30
17.15

TRACK 6: SUSTAINABLE INNOVATION IN CARE POLICY

TUE
27
JUN

16.30
18.30

TRACK 6: SUSTAINABLE INNOVATION IN CARE POLICY

THEMATIC PANEL 9

TECHNOLOGICAL INNOVATION AND SOCIAL INVESTMENT STRATEGIES IN THE CARE SECTOR: CHALLENGES AND OPPORTUNITIES

Room A

Chairs: **Francesca Bettio, Annamaria Simonazzi**

Lina Van Aerschot, Jaana Parviainen

*Robots responding to care needs?
Analyzing design strategies behind the
new generation of care robots*

Laura Aldrovandi, Giovanni Solinas

*Technological, economical and
social issues hampering homecare
approaches adoption: challenges
and opportunities. Emilia Romagna
perspective*

**Ruth Bartlett, Tula Brannelly,
Päivi Topo Forrester**

*Using GPS technologies with People
with Dementia: A systematic review
of the evidence and recommendations
for future practice*

Nobu Ishiguro

*Can technology contribute to good
care? Introducing technology into
Japanese elderly care*

THEMATIC PANEL 26

QUALITY OF CARE

Room A

Chair: **Tine Rostgaard**

Bernard Casey

Zen and the art of care delivery

Ana Paula Gil

A conceptual model to approach Elder Abuse and Neglect in residential care settings

Anneli Anttonen, Olli Karsio

Marketization from within: changing governance of care services

Tsou-Kang Hung

How to negotiate with carers to meet sexual need? -Perspectives of men with physical disabilities in Taiwan

Tine Rostgaard

Ranking quality of care in nursing homes and home care services – “all we want is some respect and proper cleaning”

WED
28
JUN

9.00
11.00

TRACK 6: SUSTAINABLE INNOVATION IN CARE POLICY

MON
26
JUN

15.30
17.15

SYMPOSIA

SYMPOSIUM 6

CHARACTERISTICS OF LONG-TERM
CARE OF THE OLDER PEOPLE –
NEW PERSPECTIVES FROM SHARE
DATA

Room B

Chairs: **Andrej Srakar, Eva Helena
Zver**

**Valentina Hlebec, Andrej Srakar,
Boris Majcen**

*LTC determinants of care
arrangements for older people in
Europe: Evidence from SHARE*

Andrej Srakar, Mateja Nagode

*Why are the older informal carers
those of better health? Solving a
causality problem*

**Boris Majcen, Joze Sambt,
Andrej Srakar**

*New measure to assess the unmet
needs for long term care using SHARE
data*

Andrej Srakar, Eva Zver

*When is GALI better than ADL and
IADL? Measures of disability of
older people and their differences in
assessing health care needs*

SYMPOSIUM 4

PROVIDING A NON-INSTITUTIONAL ENVIRONMENT IN THE NURSING HOME: PROMISING PRACTICES FROM SWEDEN?

Room B

Chair: **Håkan Jönson**

Håkan Jönson, Tove Harnett

Introducing an equal rights framework for older persons in residential care

Per Norberg

Housing elderly with medical need in Sweden – an individual entitlement to a normal life including a normal home, providing for but not depending on family members

Tove Harnett, Håkan Jönson

Accomplishing non-institutional mealtimes in nursing homes

Elisabeth Carlstedt

Profiled nursing homes on Instagram – presentations of a fun, social and active life

TUE
27
JUN

9.00
11.00

SYMPOSIA

TUE
27
JUN

14.00
16.00

SYMPOSIA

SYMPOSIUM 3

THE TRANSFORMATION OF CASH-FOR-CARE PAYMENTS FOR OLDER PEOPLE IN EUROPE

Room B

Chair: **Cristiano Gori**

Cristiano Gori, Marcello Morciano, Heinz Rothgang

The policy design of the cash-for-care payments and their role in the overall LTC system

Cristiano Gori

The regulation of care

Barbara Da Roit, Blanche Le Bihan

The regulation of care work

August Österle

The regulation of migrant care work

SYMPOSIUM 2

CHANGING POLICIES TOWARDS
FAMILY CARE AND EXTRA-FAMILIAL
CARE AND THEIR CONSEQUENCES
– THEORETICAL APPROACHES,
CONCEPTS AND TYPOLOGIES

Room B

Chairs: **Birgit Pfau-Effinger,**
Hildegard Theobald

Hildegard Theobald

*Care workers with migrant
backgrounds in formal care
services in Germany:
A multi-level intersectional analysis*

Thurid Eggers, Christopher Grages, Ralf Och, Birgit Pfau-Effinger

*Care Policies towards Familial Care
and Extra-Familial Care – Their
interaction and role for gender
equality*

Gudrun Bauer, August Österle

*Combining Paid Care Work and
Informal Care in Transnational
Settings*

Teppo Kröger

*Care poverty among older people: a
new approach to comparative care
policy research*

TUE
27
JUN

16.30
18.30

SYMPOSIA

WED
28
JUN

9.00
11.00

SYMPOSIA

SYMPOSIUM 1

PRIVATIZATION/ MARKETIZATION IN RESIDENTIAL CARE FOR OLDER PEOPLE

Room B

Chair: **Pat Armstrong**

Marta Szebehely

*The politics of profit in Swedish
welfare services*

Hugh Armstrong

*Canada on the blurring line between
not-for profit and for-profit residential
care homes*

Allyson Pollock

*UK on the impact of the growth of
large, for profit residential care chains*

Bea Mueller

*Privatization and marketization in
long-term residential care in Germany
– effects on care and care work*

Liz Lloyd

*Devalued later life: older residents'
experiences of risk and relationships
in a market system*

LIST OF REGISTERED PARTICIPANTS

Abrahamson Peter, University of Copenhagen,
pa@soc.ku.dk

Aguilar Hendrickson, Manuel Universitat de
Barcelona, *manuelaguilarhendrickson@gmail.com*

Aguilar-Cunill Carla, Universitat Rovira i Virgili,
carla.aguilar@urv.cat

Aguirre Julie, University of the basque Country,
julieaguirre08@hotmail.es

Aldrovandi Laura, Fondazione Democenter-Sipe,
l.aldrovandi@fondazione-democenter.it

Alonso Rey Natalia, Universitat Rovira i Virgili,
natalia.alonso.rey@gmail.com

Anttonen Anneli, University of Tampere,
Anneli.Anttonen@uta.fi

Arlotti Marco, DASTU, Politecnico di Milano,
marco.arlotti@polimi.it

Armstrong Pat, York University, *patarmst@yorku.ca*

Armstrong Hugh, Carleton University,
hugh.armstrong@carleton.ca

Atasu Topcuoglu Reyhan, assoc. prof.,
reyhan.atasu@gmail.com

Barbieri Dario, CGM Gruppo Cooperativo,
pierluca.ghibelli@cgm.coop

Bartlett Ruth, University of Southampton,
R.L.Bartlett@soton.ac.uk

Batthyany Karina, UDELAR, *kbatthyany@gmail.com*

Bauer Gudrun, European Centre for Social Welfare
Policy and Research, *bauer@euro.centre.org*

Baxter Kate, University of York,
kate.baxter@york.ac.uk

Bettio Francesca, Siena, *francesca.bettio@unisi.it*

Bezovan Gojko, Dep. of Social Policy, Faculty of Law,
University of Zagreb, *gojko.bezovan@pravo.hr*

Bodoque-Puerta Yolanda, Universitat Rovira i Virgili,
yolanda.bodoque@urv.cat

Bronzini Micol, Department of Economics and Social
Sciences Polytechnic University of Marche,
m.bronzini@univpm.it

Carlstedt Elisabeth, Social Work, Lund University
elisabeth.carlstedt@soch.lu.se

Casalini Brunella, University of Florence,
brunella.casalini@unifi.it

Casey Bernard, London School of Economics,
b.casey1@lse.ac.uk

Chang Chia-Ning, National Taipei University, Taiwan,
lynn92007@gmail.com

Chang Chin-fen, Institute of Sociology, Academia Sinica,
chinfen@sinica.edu.tw

Charlesworth Sara, RMIT University,
sara.charlesworth@rmit.edu.au

Chiara Guglielmetti, Università degli Studi di Milano,
chiara.guglielmetti@unimi.it

Chou Yueh-Ching, National Yang -Ming University,
choucyc@ym.edu.tw

Christensen Karen, University of Bergen,
karen.christensen@uib.no

Comas-d'Argemir Dolors, Universitat Rovira i Virgili,
dolors.comasdargemir@urv.cat

Cordini Marta, DASTU, Politecnico di Milano,
marta.cordini@polimi.it

Costa Giuseppe, Università Di Torino - Dip. Scienze Cliniche E Biologiche,
giuseppe.costa@unito.it

Da Roti Barbara, Ca' Foscari University of Venice,
barbara.daroit@unive.it

Dawson Alison, University of Stirling,
a.s.f.dawson@stir.ac.uk

Diaz Vivian, Rimisp- Latin American Center for Rural Development,
vdiaz@rimisp.org

Eggers Thurid, University of Hamburg,
thurid.eggers@wiso.uni-hamburg.de

EstevezAbe Margar, Syracuse University,
mestev02@maxwell.syr.edu

Fan Qingyun, University of Jyväskylä,
qingyun.fan@chydenius.fi

Feijten Peteke, Netherlands Institution for Social Research (SCP),
p.feijten@scp.nl

Fornasini Silvia, Bruno Kessler Foundation,
s.fornasini@fbk.eu

Fraisse Laurent, LISE (CNAM),
fraisse_laurent@orange.fr

Giordano Chiara, University of Milan / University of Brussels,
chgiora@ulb.ac.be

Giraud Olivier, CNRS,
oligiraud@ymail.com

Gori Cristiano, University of Trento, Italy

cristiano.gori@unitn.it

Graff Lea, KORA, the Danish Institute for Local and Regional Government Research, *legr@kora.dk*

Grages-Karabiner Christopher, University of Hamburg, *christopher.grages@wiso.uni-hamburg.de*

Greve Bent, Roskilde University, *bgr@ruc.dk*

Harnett Tove, Social Work, *tove.harnett@soch.lu.se*

Helena Zver Eva, IMAD, *eva.zver@gov.si*

Hudebine Herve, Université de Bretagne Occidentale, *Herve.hudebine@univ-brest.fr*

Hung Tsou-Kang, Institute of Health and Welfare Policy, National Yang-Ming University, Taipei, Taiwan, *bowpi0402@gmail.com*

Ishiguro Nobu, Osaka University, *nobuishi@yk9.so-net.ne.jp*

Johnson Abigail, University of Michigan Hospital and Health System, *abigailr@med.umich.edu*

Jönson Håkan, Social Work, Lund University, *hakan.jonson@soch.lu.se*

Jun Choi Young, Yonsei University, *sspyjc@yonsei.ac.kr*

Karsio Olli, University of Tampere, *olli.karsio@staff.uta.fi*

Kehl Konstantin, ZHAW Zurich University of Applied Sciences, *kehl@zhaw.ch*

King Shui Wong Phyllis, The Chinese University of Hong Kong, *pkswong@swk.cuhk.edu.hk*

Kovács Borbála, Central European University, *borbala.b.kovacs@gmail.com*

Kremer Monique, University of Amsterdam/WRR, *monkremer@gmail.com*

Kröger Teppo, University of Jyväskylä, *teppo.kroger@ju.fi*

Lamura Giovanni, INRCA, *g.lamura@inrca.it*

Langeland Eva, Western Norway University of Applied Sciences, *eva.langeland@hvl.no*

Lee Chih-Yao, National Yang-Ming University, *c.y.lee019@gmail.com*

León Margarita, Universitat Autònoma de Barcelona, *margarita.leon@uab.es*

Lloyd Liz, University of Bristol, *liz.lloyd@bristol.ac.uk*

Lombard, Daniel London School of Economics, *d.lombard@lse.ac.uk*

Lucas Barbara, University of Applied Sciences and Arts Western Switzerland, *barbara.lucas@hesge.ch*

Luczak Pawel, Poznan University of Economics and

Business, *pawel.luczak@ue.poznan.pl*
Luppi Matteo, Collegio Carlo Alberto,
matteo.luppi@carloalberto.org
MacInnes Julie, Centre for Health Services Studies,
University of Kent, *j.d.macinnes@kent.ac.uk*
Majcen Boris, IER, *ier@ier.si*
Martínez-Buján Raquel, University of A Corunha.
Faculty of Sociology, *rmbujan@udc.es*
Medgyesi Márton, TARKI Zrt, *medgyesi@tarki.hu*
Mendez Jennifer, Wayne State University School of
Medicine, *jmendez@med.wayne.edu*
Müller Beatrice, University of Vechta,
beatrice.mueller@uni-vechta.de
Naldini Manuela, University of Turin,
manuela.naldini@unito.it
Nazio Tiziana, Collegio Carlo Alberto,
tiziana.nazio@unito.it
Neri Stefano, Università degli Studi di Milano,
stefano.neri@unimi.it
Nies Henk, Vilans, *h.nies@vilans.nl*
Norberg Per, Lund University, *per.norberg@jur.lu.se*
Österle August, WU Vienna University of Economics,
august.oesterle@wu.ac.at
Offenhenden Maria, Rovira i Virgili University,
mariaoffenhenden@yahoo.com.ar
Ogawa Reiko, Chiba University,
reiogawa2@yahoo.co.jp
Parma Andrea, DASTU, Politecnico di Milano,
andrea.parma@polimi.it
Pasquinelli Sergio, IRS - Istituto per la Ricerca
Sociale, *spasquinelli@irsonline.it*
Paula Gil Ana, Interdisciplinary Centre of Social
Sciences – CICS.NOVA Faculdade de Ciências Sociais
e Humanas - FCSH/NOVA, *anapgil@fcsh.unl.pt*
Pfau-Effinger Birgit, University of Hamburg, Dept. of
Social Sciences, *pfau-effinger@wiso.uni-hamburg.de*
Pichler Irene, NGO, *irene.pichler@caritas-wien.at*
Poskute Viirginija, ISM University of Management
and Economics, *virpos@ism.lt*
Pozzoli Francesca, Università degli Studi di Milano,
francesca.pozzoli@unimi.it
Racz Andrea, EötvösLoránd University,
raczrubeus@gmail.com
Ranci Costanzo, DASTU, Politecnico di Milano,
costanzo.ranci@polimi.it
Rand Sigrid, Goethe University Frankfurt am Main,

s.rand@em.uni-frankfurt.de

Rodrigues Ricardo, European Centre for Social Welfare Policy and Research,

rodrigues@euro.centre.org

Rossi Paolo, University of Milano Bicocca,

paolo.rossi@unimib.it

Rossow Verena, University of Applied Sciences

Düsseldorf, *verena.rossow@hs-duesseldorf.de*

Rostgaard Tine, KORA – Danish Institute for Local and Regional Government Research, *tiro@kora.dk*

Rummery Kirstein, University of Stirling, *kirstein.*

rummery@stir.ac.uk

Sabatinelli Stefania, DASTU, Politecnico di Milano,

stefania.sabatinelli@polimi.it

Saito Yayoi, Osaka University,

ysaito@hus.osaka-u.ac.jp

Santero Arianna, University of Turin,

arianna.santero@unito.it

Saraceno Chiara, Collegio Carlo Alberto,

chiara.saraceno@unito.it

Schmidt Andrea, Austrian Public Health Institute,

andrea.schmidt@goeg.at

Schulmann Katharine, European Centre for Social

Welfare Policy Research, *judith_schreiber@gmx.at*

Sointu Liina, University of Tampere,

liina.sointu@uta.fi

Soma (Nishimura) Naoko, Yokohama National

University, *nsoma@ynu.ac.jp*

Soronellas-Masdeu Montserrat, Universitat Rovira i

Virgili, *mariamontserrat.soronellas@urv.cat*

Srakar Andrej, IER, *andrej_srakar@t-2.net*

Strohmeier Navarro Smith Rahel, Department of

Social Work, University of Applied Sciences Zurich

(ZHAW), *strrr@zhaw.ch*

Szebehely Marta, Stockholm University,

marta.szebehely@socarb.su.se

Theobald Hildegard, University of Vechta,

hildegard.theobald@uni-vechta.de

Torrens-Bonet Ramona, Universitat Rovira i Virgili,

ramona.torrens@urv.cat

Trifiletti Rossana, Università degli studi di Firenze,

rtrifil@unifi.it

Ulmanen Petra, Stockholm University, Department of

Social Work, *petra.ulmanen@socarb.su.se*

Vabø Mia, NOVA, University of Applied Sciences,

mia.vabo@nova.hioa.no

Valvis Zafiris , University of Piraeus,
zvalvis@gmail.com

Van Aerschot Lina, University of Amsterdam/WRR,
lina.van.aerschot@uta.fi

Wei Shu-er, dept. of Life-and Death Studies, Uanhua
University, *sewei@mail.nhu.edu.tw*

Westendorp Rudi, University of Copenhagen,
westendorp@sund.ku.dk

Yamashita Junko, University of Bristol,
J.Yamashita@bristol.ac.uk

Yeandle Sue, University of Sheffield,
s.yeandle@sheffield.ac.uk

Yun Tae-Young, Georg-August University of
Goettingen, *taeyyun@gmail.com*

Zingmark Magnus, Umeå University,
magnus.zingmark@ostersund.se

Legazpe Moraleja, Universidad De Castilla-La
Mancha, *Nuria.Legazpe@uclm.es*



NOTE



A series of 20 horizontal dotted lines for writing notes.

